

RESOLUTION NO. 23-04

**RESOLUTION EXPANDING RURAL SPECIAL
IMPROVEMENT MAINTENANCE DISTRICT #847M
(THE NINES SUBDIVISION)**

WHEREAS, pursuant to §7-12-2161(4), MCA, the Commissioners have the power of changing, by resolution, the boundaries of any maintenance district not more than once a year; and

WHEREAS the boundaries of RSID 847M have not been changed within the last year; and

WHEREAS, it has been determined that properties adjacent to the existing Rural Special Improvement District #847M boundaries are benefited properties accessing the roads; and

WHEREAS, the benefited property status requires the expansion of boundaries for RSID 847M for the maintenance of the roads located within the district boundaries; and

WHEREAS, the boundaries of the district will be expanded to include The Nines Subdivision, Phase 2 and 3, Yellowstone County, Montana, and

WHEREAS, lots to be added to the district and boundaries of the expanded district are shown in Exhibit A (map).

NOW, THEREFORE, BE IT RESOLVED by the Board of County Commissioners of Yellowstone County, Montana, deeming the public interest or convenience require, intends to expand the following described Rural Special Improvement Maintenance District:

- 1. DESCRIPTION OF IMPROVEMENTS, DESCRIPTION OF MAINTENANCE, METHOD OF ASSESSMENT AND ESTIMATED COSTS.** Assessments collected on behalf of this district shall be used for the maintenance of the road within the boundaries of this district. All of the costs of the district shall be assessed equally on a per lot method for existing and future lots. Assessments will be established annually by the Board of County Commissioners and are subject to adjustment due to cost fluctuations related to maintenance utilization levels and changes in material and labor costs of performing necessary maintenance.
- 2. DURATION.** The district shall be deemed to be perpetual in nature unless absorbed and replaced by another district or municipality.

Page 2
Resolution Expanding
RSID #847M

PASSED AND ADOPTED by the Board of County Commissioners of Yellowstone
County, Montana, this 17th day of January, 2023.

BOARD OF COUNTY COMMISSIONERS
YELLOWSTONE COUNTY, MONTANA



John Ostlund, Chairman

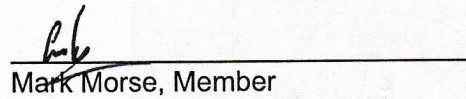

Mark Morse, Member

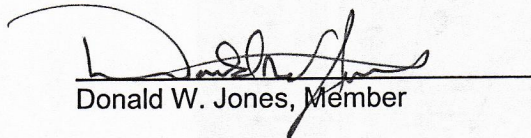

Donald W. Jones, Member

(SEAL)
ATTEST:

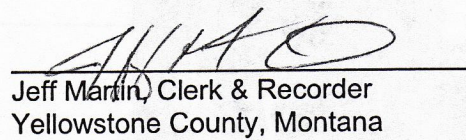

Jeff Martin, Clerk & Recorder
Yellowstone County, Montana

Exhibit A

Expansion for RSID 847M

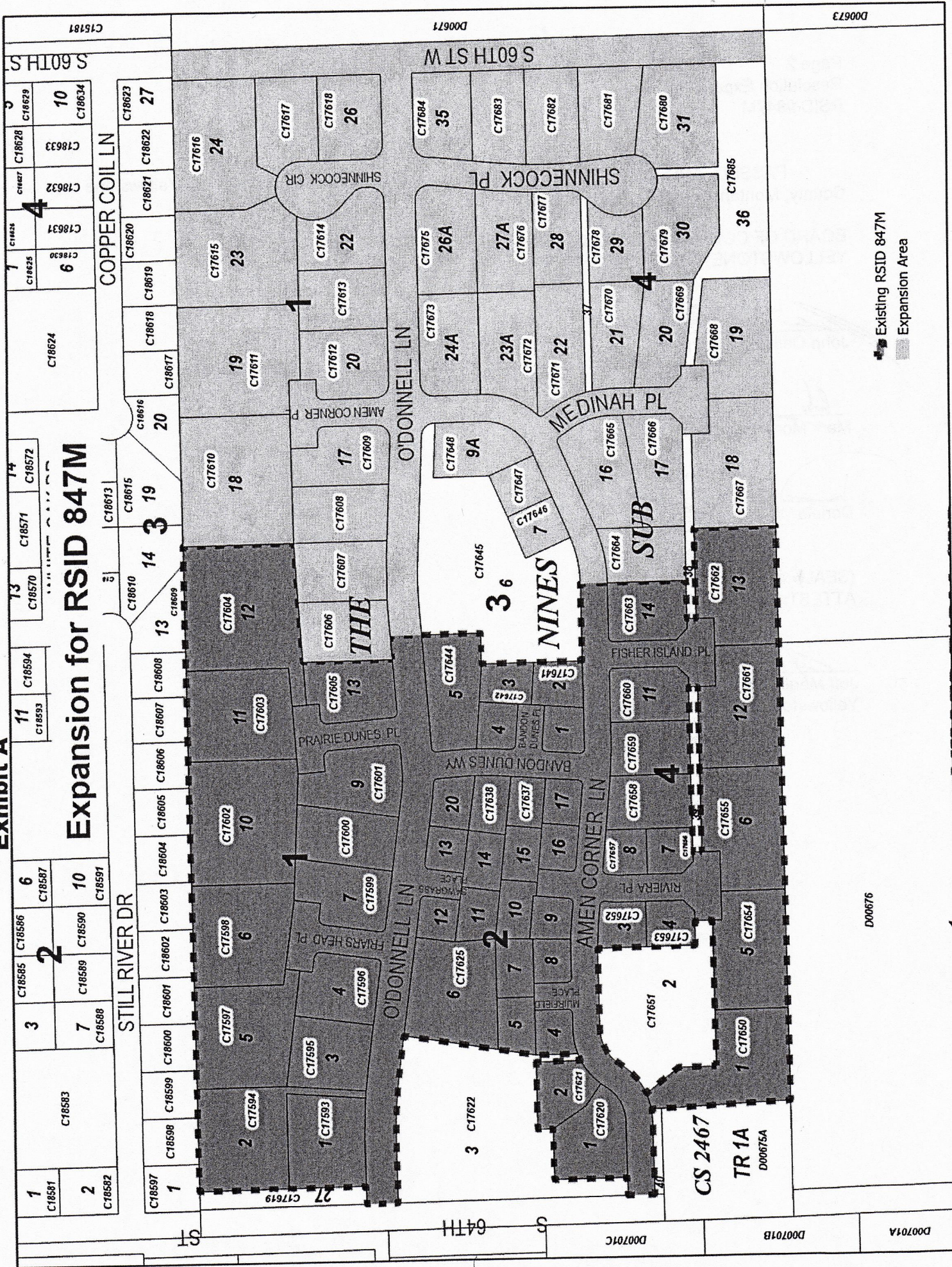

Existing RSID 847M
Expansion Area

D00673

D00676

D00701A

D00701B

D00701C

D00701D

C15181

D00671

1	C18581	3	C18585	6	C18586	11	C18594	13	C18570	14	C18571	14	C18572
2	C18582	7	C18588	2	C18589	10	C18593	13	C18609	19	C18613	19	C18615
	C18583	4	C18596	10	C18590	10	C18594	13	C18608	3	C18613	3	C18615
		7	C18589	10	C18590	10	C18593	13	C18608	14	C18613	14	C18615
		1	C18588	10	C18590	10	C18593	13	C18608	19	C18613	19	C18615
		2	C18588	10	C18590	10	C18593	13	C18608	19	C18613	19	C18615

COPPER COLLN

STILL RIVER DR

O'DONNELL LN

O'DONNELL LN

O'DONNELL LN

O'DONNELL LN

S 60TH ST W

SHINNECOCK PL

MEDINAH PL

NINES

AMEN CORNER LN

AMEN CORNER P

SHINNECOCK CIR

FISHER ISLAND PL

BANDON DUNES WY

PRAIRIE DUNES PL

BANDON DUNES PL

BANDON DUNES PL

FISHER ISLAND PL

FISHER ISLAND PL

FISHER ISLAND PL

FISHER ISLAND PL

FISHER ISLAND PL

FISHER ISLAND PL

FISHER ISLAND PL

FISHER ISLAND PL

FISHER ISLAND PL

FISHER ISLAND PL

FISHER ISLAND PL

FISHER ISLAND PL

FISHER ISLAND PL

FISHER ISLAND PL

FISHER ISLAND PL

FISHER ISLAND PL

FISHER ISLAND PL

FISHER ISLAND PL

FISHER ISLAND PL

FISHER ISLAND PL

FISHER ISLAND PL

FISHER ISLAND PL

FISHER ISLAND PL

FISHER ISLAND PL

FISHER ISLAND PL

Exhibit B

Existing RSID 847M

Owner name	Tax Code	Legal Description	Mail Address1	City	State	Zipcode
P3COLEMAN LLC	C17606	THE NINES SUB (19), S17, T01 S, R25 E, BLOCK 1, Lot 14	PO BOX 1555	BILLINGS	MT	59103-1555
P3COLEMAN LLC	C17607	THE NINES SUB (19), S17, T01 S, R25 E, BLOCK 1, Lot 15	PO BOX 1555	BILLINGS	MT	59103-1555
P3COLEMAN LLC	C17608	THE NINES SUB (19), S17, T01 S, R25 E, BLOCK 1, Lot 16	PO BOX 1555	BILLINGS	MT	59103-1555
P3COLEMAN LLC	C17609	THE NINES SUB (19), S17, T01 S, R25 E, BLOCK 1, Lot 17	PO BOX 1555	BILLINGS	MT	59103-1555
SCOTT, LYNETTE	C17610	THE NINES SUB (19), S17, T01 S, R25 E, BLOCK 1, Lot 18	213 BOSTON HILL RD	BILLINGS	MT	59102-6865
P3COLEMAN LLC	C17611	THE NINES SUB (19), S17, T01 S, R25 E, BLOCK 1, Lot 19	PO BOX 1555	BILLINGS	MT	59103-1555
P3COLEMAN LLC	C17612	THE NINES SUB (19), S17, T01 S, R25 E, BLOCK 1, Lot 20	PO BOX 1555	BILLINGS	MT	59103-1555
P3COLEMAN LLC	C17613	THE NINES SUB (19), S17, T01 S, R25 E, BLOCK 1, Lot 21	PO BOX 1555	BILLINGS	MT	59103-1555
P3COLEMAN LLC	C17614	THE NINES SUB (19), S17, T01 S, R25 E, BLOCK 1, Lot 22	PO BOX 1555	BILLINGS	MT	59103-1555
P3COLEMAN LLC	C17615	THE NINES SUB (19), S17, T01 S, R25 E, BLOCK 1, Lot 23	PO BOX 1555	BILLINGS	MT	59103-1555
P3COLEMAN LLC	C17616	THE NINES SUB (19), S17, T01 S, R25 E, BLOCK 1, Lot 24	PO BOX 1555	BILLINGS	MT	59103-1555
P3COLEMAN LLC	C17617	THE NINES SUB (19), S17, T01 S, R25 E, BLOCK 1, Lot 25	PO BOX 1555	BILLINGS	MT	59103-1555
P3COLEMAN LLC	C17618	THE NINES SUB (19), S17, T01 S, R25 E, BLOCK 1, Lot 26	PO BOX 1555	BILLINGS	MT	59103-1555
LOESCH, HEATHER	C17646	THE NINES SUB (19), S17, T01 S, R25 E, BLOCK 3, Lot 7	1716 ALPINE MEADOWS LN	PRESCOTT	AZ	86303-6923
P3COLEMAN LLC	C17647	THE NINES SUB (19), S17, T01 S, R25 E, BLOCK 3, Lot 8	PO BOX 1555	BILLINGS	MT	59103-1555
P3COLEMAN LLC	C17648	THE NINES SUB (19), S17, T01 S, R25 E, BLOCK 3, Lot 9A, AM	PO BOX 1555	BILLINGS	MT	59103-1555
P3COLEMAN LLC	C17664	THE NINES SUB (19), S17, T01 S, R25 E, BLOCK 4, Lot 15	PO BOX 1555	BILLINGS	MT	59103-1555
P3COLEMAN LLC	C17665	THE NINES SUB (19), S17, T01 S, R25 E, BLOCK 4, Lot 16	PO BOX 1555	BILLINGS	MT	59103-1555
P3COLEMAN LLC	C17666	THE NINES SUB (19), S17, T01 S, R25 E, BLOCK 4, Lot 17	PO BOX 1555	BILLINGS	MT	59103-1555
GREEN, CHAD D & BAILEY MORGAN	C17667	THE NINES SUB (19), S17, T01 S, R25 E, BLOCK 4, Lot 18	1121 VICTORY AVE	BILLINGS	MT	59105-1856
P3COLEMAN LLC	C17668	THE NINES SUB (19), S17, T01 S, R25 E, BLOCK 4, Lot 19	PO BOX 1555	BILLINGS	MT	59103-1555
P3COLEMAN LLC	C17669	THE NINES SUB (19), S17, T01 S, R25 E, BLOCK 4, Lot 20	PO BOX 1555	BILLINGS	MT	59103-1555
P3COLEMAN LLC	C17670	THE NINES SUB (19), S17, T01 S, R25 E, BLOCK 4, Lot 21	PO BOX 1555	BILLINGS	MT	59103-1555
P3COLEMAN LLC	C17671	THE NINES SUB (19), S17, T01 S, R25 E, BLOCK 4, Lot 22	PO BOX 1555	BILLINGS	MT	59103-1555
BIG SKY SOUTH LLC	C17672	THE NINES SUB (19), S17, T01 S, R25 E, BLOCK 4, Lot 23A, (:	3319 JACK BURKE LN	BILLINGS	MT	59106-1111
BIG SKY SOUTH LLC	C17673	THE NINES SUB (19), S17, T01 S, R25 E, BLOCK 4, Lot 24A, (:	3319 JACK BURKE LN	BILLINGS	MT	59106-1111
BIG SKY SOUTH LLC	C17675	THE NINES SUB (19), S17, T01 S, R25 E, BLOCK 4, Lot 26A, (:	3319 JACK BURKE LN	BILLINGS	MT	59106-1111
BIG SKY SOUTH LLC	C17676	THE NINES SUB (19), S17, T01 S, R25 E, BLOCK 4, Lot 27A, (:	3319 JACK BURKE LN	BILLINGS	MT	59106-1111
P3COLEMAN LLC	C17677	THE NINES SUB (19), S17, T01 S, R25 E, BLOCK 4, Lot 28	PO BOX 1555	BILLINGS	MT	59103-1555
MCDONNELL, MATTHEW J & LINDSEY N	C17678	THE NINES SUB (19), S17, T01 S, R25 E, BLOCK 4, Lot 29	2627 SOUTHRIDGE DR	BILLINGS	MT	59102-7961
MCDONNELL, MATTHEW J & LINDSEY N	C17679	THE NINES SUB (19), S17, T01 S, R25 E, BLOCK 4, Lot 30	2627 SOUTHRIDGE DR	BILLINGS	MT	59102-7961
P3COLEMAN LLC	C17680	THE NINES SUB (19), S17, T01 S, R25 E, BLOCK 4, Lot 31	PO BOX 1555	BILLINGS	MT	59103-1555
P3COLEMAN LLC	C17681	THE NINES SUB (19), S17, T01 S, R25 E, BLOCK 4, Lot 32	PO BOX 1555	BILLINGS	MT	59103-1555
P3COLEMAN LLC	C17682	THE NINES SUB (19), S17, T01 S, R25 E, BLOCK 4, Lot 33	PO BOX 1555	BILLINGS	MT	59103-1555
P3COLEMAN LLC	C17683	THE NINES SUB (19), S17, T01 S, R25 E, BLOCK 4, Lot 34	PO BOX 1555	BILLINGS	MT	59103-1555
P3COLEMAN LLC	C17684	THE NINES SUB (19), S17, T01 S, R25 E, BLOCK 4, Lot 35	PO BOX 1555	BILLINGS	MT	59103-1555

Properties to be added

Owner name	Tax Code	Legal Description	Mail Address1	City	State	Zipcode
P3COLEMAN LLC	C17593	THE NINES SUB (19), S17, T01 S, R25 E, BLOCK 1, Lot 1	PO BOX 1555	BILLINGS	MT	59103-1555
JOHNSON, MARK R & SANDRA D	C17594	THE NINES SUB (19), S17, T01 S, R25 E, BLOCK 1, Lot 2	PO BOX 928	HARDIN	MT	59034-0928
P3COLEMAN LLC	C17595	THE NINES SUB (19), S17, T01 S, R25 E, BLOCK 1, Lot 3	PO BOX 1555	BILLINGS	MT	59103-1555
MURPHY, MALOREE	C17596	THE NINES SUB (19), S17, T01 S, R25 E, BLOCK 1, Lot 4	2615 CASTLE PINE CIR S	BILLINGS	MT	59101-9427
ERICKSON, MARK C & CHELSEA	C17597	THE NINES SUB (19), S17, T01 S, R25 E, BLOCK 1, Lot 5	1222 FRIARS HEAD PL	BILLINGS	MT	59106-3145
WALTER, MELISSA A & CALVIN J	C17598	THE NINES SUB (19), S17, T01 S, R25 E, BLOCK 1, Lot 6	1221 FRIARS HEAD PL	BILLINGS	MT	59106-3145
VISIONARY CUSTOM HOMES, LLC	C17599	THE NINES SUB (19), S17, T01 S, R25 E, BLOCK 1, Lot 7	6729 COVE CREEK DR	BILLINGS	MT	59106-2226
P3COLEMAN LLC	C17600	THE NINES SUB (19), S17, T01 S, R25 E, BLOCK 1, Lot 8	PO BOX 1555	BILLINGS	MT	59103-1555
BROSOVICH INVESTMENTS INC	C17601	THE NINES SUB (19), S17, T01 S, R25 E, BLOCK 1, Lot 9	4295 RANGEVIEW DR	BILLINGS	MT	59106-4738
BUTLER, THOMAS M & KATHY M	C17602	THE NINES SUB (19), S17, T01 S, R25 E, BLOCK 1, Lot 10	4525 RIO VISTA DR	BILLINGS	MT	59106-1578
GUZMAN, GLENN & SUSAN	C17603	THE NINES SUB (19), S17, T01 S, R25 E, BLOCK 1, Lot 11	1221 PRAIRIE DUNES PL	BILLINGS	MT	59106-3146
HOINESS, BRAYDON & KATRINA	C17604	THE NINES SUB (19), S17, T01 S, R25 E, BLOCK 1, Lot 12	626 CHERRY HILLS RD	BILLINGS	MT	59105-3655
P3COLEMAN LLC	C17605	THE NINES SUB (19), S17, T01 S, R25 E, BLOCK 1, Lot 13	PO BOX 1555	BILLINGS	MT	59103-1555
P3COLEMAN LLC	C17620	THE NINES SUB (19), S17, T01 S, R25 E, BLOCK 2, Lot 1	PO BOX 1555	BILLINGS	MT	59103-1555
PATTERSON, LARRY R & TONYA L	C17621	THE NINES SUB (19), S17, T01 S, R25 E, BLOCK 2, Lot 2	6321 AMEN CORNER LN	BILLINGS	MT	59106-3231
P3COLEMAN LLC	C17623	THE NINES SUB (19), S17, T01 S, R25 E, BLOCK 2, Lot 4	PO BOX 1555	BILLINGS	MT	59103-1555
P3COLEMAN LLC	C17624	THE NINES SUB (19), S17, T01 S, R25 E, BLOCK 2, Lot 5	PO BOX 1555	BILLINGS	MT	59103-1555
P3COLEMAN LLC	C17625	THE NINES SUB (19), S17, T01 S, R25 E, BLOCK 2, Lot 6	PO BOX 1555	BILLINGS	MT	59103-1555
P3COLEMAN LLC	C17626	THE NINES SUB (19), S17, T01 S, R25 E, BLOCK 2, Lot 7	PO BOX 1555	BILLINGS	MT	59103-1555
P3COLEMAN LLC	C17627	THE NINES SUB (19), S17, T01 S, R25 E, BLOCK 2, Lot 8	PO BOX 1555	BILLINGS	MT	59103-1555
P3COLEMAN LLC	C17628	THE NINES SUB (19), S17, T01 S, R25 E, BLOCK 2, Lot 9	PO BOX 1555	BILLINGS	MT	59103-1555
P3COLEMAN LLC	C17629	THE NINES SUB (19), S17, T01 S, R25 E, BLOCK 2, Lot 10	PO BOX 1555	BILLINGS	MT	59103-1555
P3COLEMAN LLC	C17630	THE NINES SUB (19), S17, T01 S, R25 E, BLOCK 2, Lot 11	PO BOX 1555	BILLINGS	MT	59103-1555
P3COLEMAN LLC	C17631	THE NINES SUB (19), S17, T01 S, R25 E, BLOCK 2, Lot 12	PO BOX 1555	BILLINGS	MT	59103-1555
P3COLEMAN LLC	C17632	THE NINES SUB (19), S17, T01 S, R25 E, BLOCK 2, Lot 13	PO BOX 1555	BILLINGS	MT	59103-1555
P3COLEMAN LLC	C17633	THE NINES SUB (19), S17, T01 S, R25 E, BLOCK 2, Lot 14	PO BOX 1555	BILLINGS	MT	59103-1555
FORMATION INC	C17634	THE NINES SUB (19), S17, T01 S, R25 E, BLOCK 2, Lot 15	PO BOX 1124	BILLINGS	MT	59103-1124
P3COLEMAN LLC	C17635	THE NINES SUB (19), S17, T01 S, R25 E, BLOCK 2, Lot 16	PO BOX 1555	BILLINGS	MT	59103-1555
P3COLEMAN LLC	C17636	THE NINES SUB (19), S17, T01 S, R25 E, BLOCK 2, Lot 17	PO BOX 1555	BILLINGS	MT	59103-1555
P3COLEMAN LLC	C17637	THE NINES SUB (19), S17, T01 S, R25 E, BLOCK 2, Lot 18	PO BOX 1555	BILLINGS	MT	59103-1555
BRANDT, ROBERT B & STEPHANIE M	C17638	THE NINES SUB (19), S17, T01 S, R25 E, BLOCK 2, Lot 19	1314 BANDON DUNES WAY	BILLINGS	MT	59106
P3COLEMAN LLC	C17639	THE NINES SUB (19), S17, T01 S, R25 E, BLOCK 2, Lot 20	PO BOX 1555	BILLINGS	MT	59103-1555
P3COLEMAN LLC	C17640	THE NINES SUB (19), S17, T01 S, R25 E, BLOCK 3, Lot 1	PO BOX 1555	BILLINGS	MT	59103-1555
TRIPPLE, GREGORY D &	C17641	THE NINES SUB (19), S17, T01 S, R25 E, BLOCK 3, Lot 2	6202 BANDON DUNES PL	BILLINGS	MT	59106-3153
P3COLEMAN LLC	C17642	THE NINES SUB (19), S17, T01 S, R25 E, BLOCK 3, Lot 3	PO BOX 1555	BILLINGS	MT	59103-1555
P3COLEMAN LLC	C17643	THE NINES SUB (19), S17, T01 S, R25 E, BLOCK 3, Lot 4	PO BOX 1555	BILLINGS	MT	59103-1555
P3COLEMAN LLC	C17644	THE NINES SUB (19), S17, T01 S, R25 E, BLOCK 3, Lot 5	PO BOX 1555	BILLINGS	MT	59103-1555
HEIN, JEREMY M & TIFFANI K	C17650	THE NINES SUB (19), S17, T01 S, R25 E, BLOCK 4, Lot 1	3641 S 56TH ST W UNIT 1	BILLINGS	MT	59101-6130
WILLIAMS, DUSTAN &	C17652	THE NINES SUB (19), S17, T01 S, R25 E, BLOCK 4, Lot 3	PO BOX 17468	MISSOULA	MT	59808-7468
KRIEGER, JEFF & EMILY	C17653	THE NINES SUB (19), S17, T01 S, R25 E, BLOCK 4, Lot 4	1330 RIVIERA PL	BILLINGS	MT	59106-3233
MARANDA, ERIC L &	C17654	THE NINES SUB (19), S17, T01 S, R25 E, BLOCK 4, Lot 5	1336 RIVIERA PL	BILLINGS	MT	59106-3233
COLEMAN, JAMES R & KELLY P	C17655	THE NINES SUB (19), S17, T01 S, R25 E, BLOCK 4, Lot 6	PO BOX 1555	BILLINGS	MT	59103-1555

Owner name	Tax Code	Legal Description	Mail Address1	City	State	Zipcode
EICHLER, DAVID & DIANE	C17656	THE NINES SUB (19), S17, T01 S, R25 E, BLOCK 4, Lot 7	1607 17TH ST W APT 334	BILLINGS	MT	59102-2947
P3COLEMAN LLC	C17657	THE NINES SUB (19), S17, T01 S, R25 E, BLOCK 4, Lot 8	PO BOX 1555	BILLINGS	MT	59103-1555
MORT, TIM & EVELYN	C17658	THE NINES SUB (19), S17, T01 S, R25 E, BLOCK 4, Lot 9	6210 AMEN CORNER LN	BILLINGS	MT	59106-3218
MORT, TIM & EVELYN	C17659	THE NINES SUB (19), S17, T01 S, R25 E, BLOCK 4, Lot 10	6210 AMEN CORNER LN	BILLINGS	MT	59106-3218
LARSON, KEVIN	C17660	THE NINES SUB (19), S17, T01 S, R25 E, BLOCK 4, Lot 11	1332 FISHER ISLAND PL	BILLINGS	MT	59106-3235
BAN, BRIAN P & TANA K	C17661	THE NINES SUB (19), S17, T01 S, R25 E, BLOCK 4, Lot 12	1340 FISHER ISLAND PL	BILLINGS	MT	59106-3235
JAMES & MARILYN SHAW LIVING TRUST	C17662	THE NINES SUB (19), S17, T01 S, R25 E, BLOCK 4, Lot 13	1337 FISHER ISLAND PL	BILLINGS	MT	59106-3235
JAMES & MARILYN SHAW LIVING TRUST	C17663	THE NINES SUB (19), S17, T01 S, R25 E, BLOCK 4, Lot 14	1337 FISHER ISLAND PL	BILLINGS	MT	59106-3235